

# DVORANA POVODNI MOŽ POVODNI MOŽ HALL

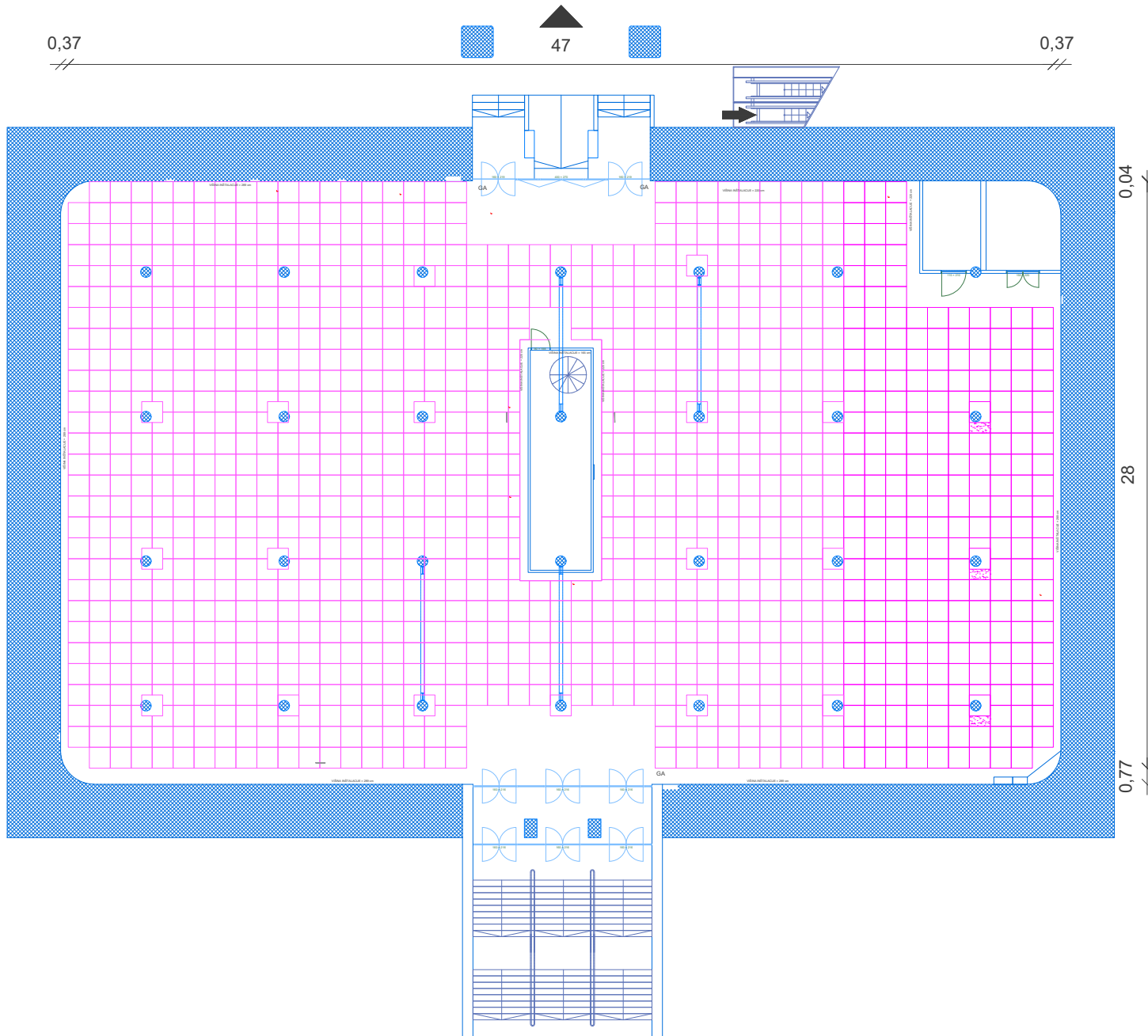

## STEBRNA DVORANA STEBRNA HALL

□ 1.00 × 1.00 M

VIŠINA / HEIGHT	2.90 m
POVRŠINA / SURFACE	1299.42 m <sup>2</sup>
SEJEMSKA POVRŠINA - MREŽA / SUFRACE - NET	1169 m <sup>2</sup>
NOSILNOST TAL / LOAD CAPACITY OF FLOOR	500 kg/m <sup>2</sup>

- VODA IN KANALIZACIJA / WATER AND DRAINAGE
- ELEKTRIKA 400V 16-32A / ELECTRICITY 400V 16-32A
- ELEKTRIKA 230/400V 16-32A / ELECTRICITY 230/400V 16-32A
- TELEFON - INTERNET / TELEPHONE - INTERNET
- GASILNIKI / HYDRANT
- GA OBVEZEN DOSTOP / OBLIGATORY ACCESS
- SMER REŠEVANJA / EMERGENCY EXIT

POSEG V KONSTRUKCIJO OBJEKTA NI DOVOLJEN!  
OPERATIONS PERFORMED INTO THE CONSTRUCTION ARE NOT ALLOWED!

STROPNA KONSTRUKCIJA NI NOSILNA!  
THE CEILING CONSTRUCTION IS NOT LOAD CARRYING!

OPOMBA: MERE VEDNO PREVERITI NA MESTU!  
NOTE: ALWAYS CHECK MEASUREMENTS ON THE SITE!